

Basic set for Exafill S bath filler finish set with waste and overflow set for special bath tubs

Surfaces: n.a. Article Number: **58116180**



Description

product features

- suitable for special bath tubs, with bellows for bath tubs with slanted bath rim
- bowden cable length 780 mm
- supply hose water connection left DN20
- P-IX 19141/I
- P-IX 19141/I
- LGA Zertifikats-Nr. 5371053 Bauart geprüft und überwacht
- DVGW NW-6506BN0685
- WRAS 1512028
- Kiwa K6522/02
- SVGW 0004-4251
- SVGW 0004-4251
- SVGW 0004-4251

consists of

- Bath tub trap (#56373XXX)

Mandatory Accessoires

- Exafill S bath filler finish set (#58117XXX)
- Flexible connection tube 600 mm (#58191XXX)
- Flexible connection tube 800 mm (#58192XXX)

Product image



Scale drawing

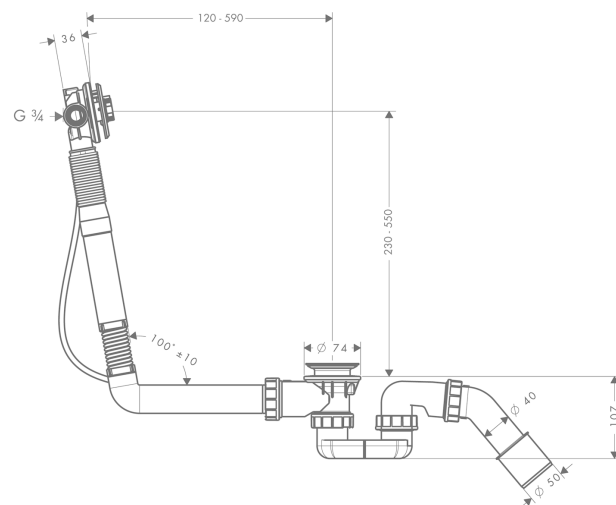

Basic set for Exafill S bath filler finish set with waste and overflow set for special bath tubs

Surfaces: n.a. Article Number: 58116180



Exploded Drawing

Year of production: >04/07

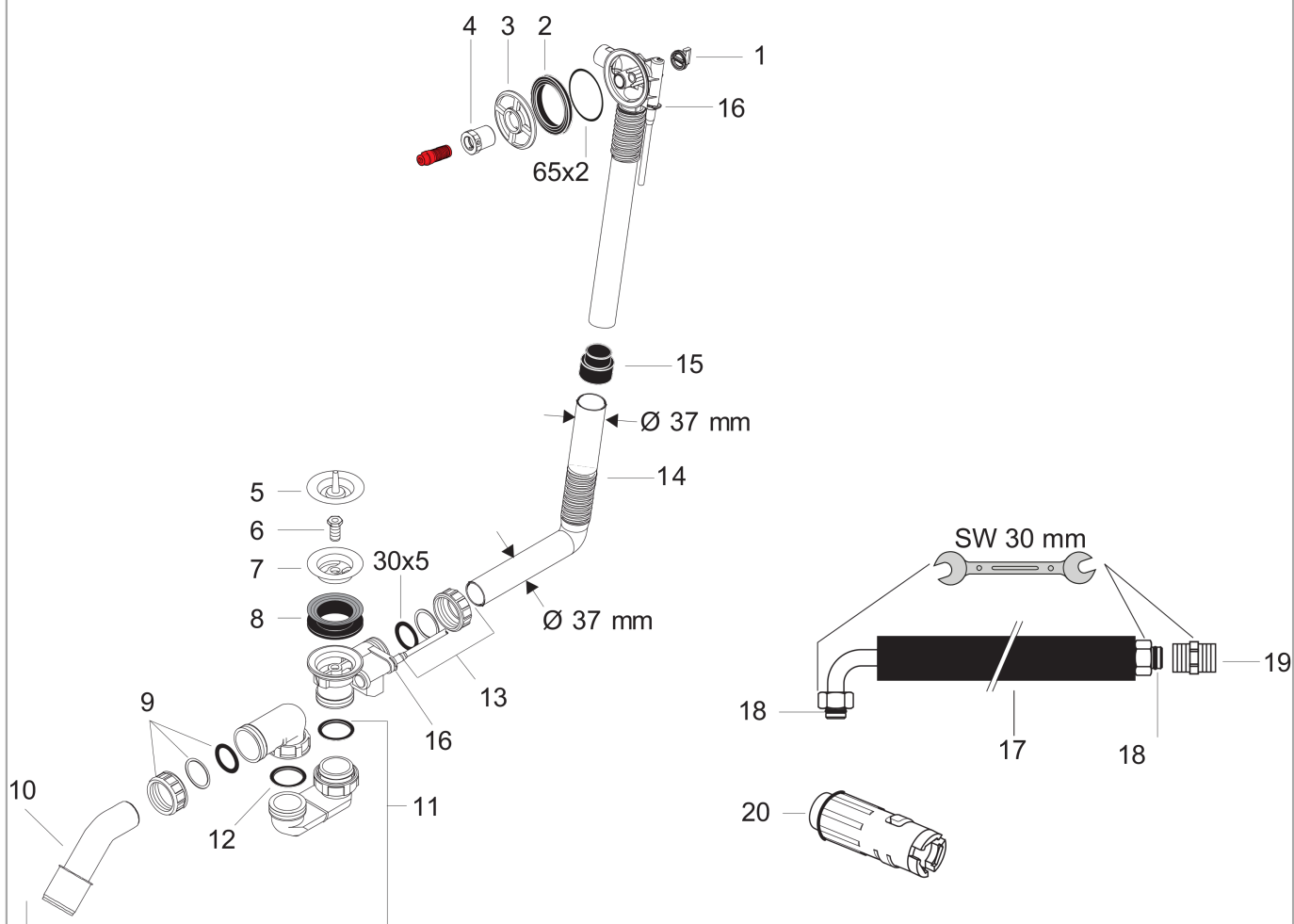

Basic set for Exafill S bath filler finish set with waste and overflow set for special bath tubs

Surfaces: n.a. Article Number: **58116180**



Spare part list

Year of production: >04/07

Pos.	Description	Article Number	PC	PU
1	cover	97580000	1	1
2	form ring	95969000	4	1
3	fixing ring	97579000	6	1
4	locking screw	97573000	10	1
5	plug	97577000	1	1
6	hollow screw	94301000	2	1
7	jumber plate	97581000	6	1
8	triple seal	96093000	3	1
9	sleeve nut	96332000	3	1
10	bent outlet	96221000	3	1
11	trap cpl.	56373000	0	1
12	flat seal	98075000	3	1
13	sleeve nut	95424000	2	1
14	original spare part no longer available, replaced with pipe bend	98126000	8	1
15	packing	97578000	5	1
16	O-ring 30x5	98153000	1	1
17	connection hose	58192000	0	1
19	O-ring 16x2,5	98134000	1	1
18	connecting thread G $\frac{3}{4}$	96143000	5	1
20	special tool set	58085000	3	1